

UNLESS OTHERWISE SPECIFIED MANUFACTURE PER ALLEN INSTITUTE WORKMANSHIP STANDARD

MINIMUM CONTENT DRAWING. MANUFACTURE TO 3D MODEL WITHIN +/- 0.25mm UNLESS OTHERWISE SPECIFIED. REFER TO 3D MODEL FOR UNSPECIFIED DIMENSIONS.

REVISIONS		
REV.	DESCRIPTION	DATE
A	ADDED CLEARANCE NOTCH	10/19/2023

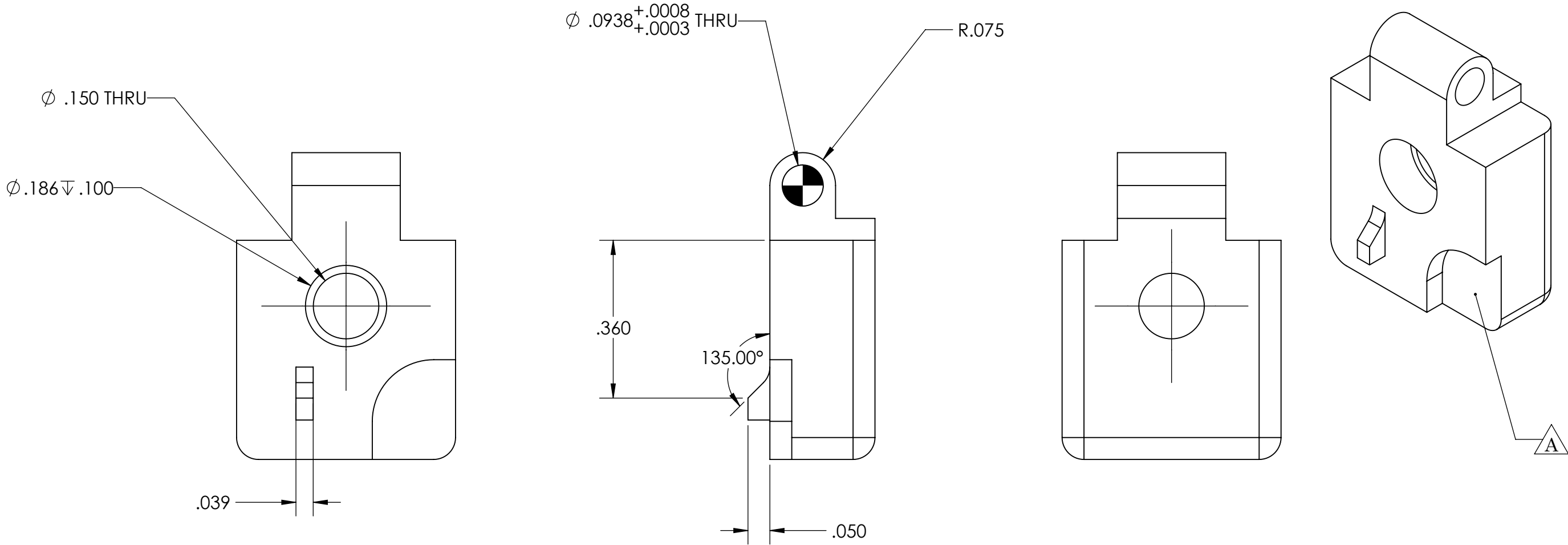

MATERIAL 6061 Alloy	UNLESS OTHERWISE SPECIFIED: DIMENSIONS ARE IN MILLIMETERS TOLERANCES:		PROPRIETARY AND CONFIDENTIAL. CONTACT ALLEN INSTITUTE FOR RULES REGARDING HANDLING		ALLEN INSTITUTE		615 Westlake Ave N Seattle, WA 98109, USA Phone: +1-206-548-7000 www.alleninstitute.org	
FINISH	DECIMAL    ± .1            ANGULAR: MACH ± 2°		TITLE: HINGE CLAMP, CRANIOTOMY					
TREATMENT	BREAK ALL EDGES .5 MAX INTERPRET PER ASME Y14.5-2018 MAX ROUGHNESS 1.6 micrometers		DRAWN <i>alex.cahoon</i>	DATE 10/19/2023	SIZE <b>B</b>	DWG. NO. <b>0155-100-06</b>		REV <b>A</b>
COLOR	THIRD ANGLE PROJECTION		DO NOT SCALE DRAWING		SCALE: 4:1	WEIGHT (g):0.01		SHEET 1 OF 1